

Newlin Hall Carpentry and General Specs

NEWLIN HALL AUDIENCE CAPACITY

Capacity with Orchestra Pit Seats: 1,474
 without Orchestra Pit Seats: 1,428
Orchestra level with Pit seats: 282
Orchestra level without Pit seats: 236
Grand Tier level: 1,192

STAGE DIMENSIONS

Proscenium width: 56 ft.
Height 28'. Valence can bring height down to 20'
Plaster line to rear wall: 38 ft.
 To last line set: 31 ft. 7 in.
 To front of apron: 5 ft.
Orchestra Lift (hydraulic) DS of Apron: Width = 48 ft., Depth = 12 ft.
Center Line to SL Wall: Clear 50 ft.
 To SR Fly Rail: Clear 45 ft.

LOADING CONDITIONS and Parking

Truck Height Loading dock will accommodate 2 trailers.
Dock door opening: 10 ft. x 10 ft.
The loading dock opens into the Scene Shop, which opens onto stage through another 10' x 10' door. Trucks are free to remain at the loading dock until loadout. Buses should park on the far side of the trucks, closer to the soccer field.
No Shore power. Running on Generator is allowed.
Loading Dock address (different than shipping address)
99 Charleston Green. Danville, KY. 40422 on google maps is the loading dock.
Ride Sharing companies provide limited service in this area. Please notify Norton



Center Staff if transportation is required.

FLY SYSTEM

Type: Counter weight

Single Purchase: 31 Lines

Double Purchase: 3 lines

1 Electric winch operated lighting bridge

Trim & Battens:

High Trim: 49' 6".

Low Trim: 5' above stage floor

Battens: 56' long

Approximate amount of counter weight in house: 10,000 LBS

-The counter weight battens are 1 ½ inch nps pipe with 5 lines per batten.

Working load of 250 LBS per line, 1250LBS per batten.

-Working load of the lighting bridge is 1500 LBS.

The loading rail is SR and is 20'6". above the stage floor.

The loading gallery rail is 47' from the stage floor.

Newlin Hall does not have a grid, there are 5 upstage to downstage catwalks that allow access to rigging steel. These beams are 2"high by 9" wide and the bottom of the beam is 56'off the floor. There are 5 rigging beams spaced at 0' (center line), 2 at 12' off center, and 2 at 24' off center both SL and SR.

STAGE FLOOR

The wooden floor is 56' wide by 35' deep, SR wing space is a concrete floor 18' wide by 35' deep, and SL wing space is a concrete floor 16' wide by 35' deep.

Sprung Floor: yellow pine over plywood over 1 x 3 sleepers sprung on neoprene pads.

Traps: None

Color: Flat black

Lagging into the floor is allowed



STAGE DRAPERIES

Type	No.	Dimensions	Color	Flies	Travels
Main Valance	1	60' x 10' high	Gold	Yes	
Main Curtain	1	60' x 25'6 high	Gold	Yes	Yes
Legs	8	15' x 30' high	Black		
Black Out Panel	2	30' x 30' high	Flat black		
Borders	4	60' x 10' high	Black		
Cyc seamless	1	56' x 30' high	Natural		
Scrim	1	56' x 30' high	Black		

Newlin Hall Sound Shell:

There is a large built-in (movable) orchestra shell over the stage. This includes 4 side panels and a ceiling section complete with PAR 56 overhead lighting. When not in use, the ceiling folds up against the upstage wall. There is a 6 ft. wide rear crossover under the shell roof upstage for the last line set. The side walls divide mid-stage into 2 halves and swing and store against the DS and US walls.



NEWLIN HALL LINE SETS

Line #	Dist. from plaster line	Typical house hang	Weight	Show hang	Notes
1	1'4"	valance		valance	
2	1'8"	main		main	
3	2'8"				
4	3'1"				62' pipe
Lt. Bridge	4'1" to 5'0"	bridge		electric	
5	5'8"				
6	6'8"				
7	7'0"				
8	7'9"				
9	8'4"				
10	9'1"				
11	11'0"				
12	12'0"				
13	12'8"				
14	13'3"				
15	13'9"				
16	14'6"				
17	14'9"				
18	15'0"				
19	16'2"				
20	17'3"				



21	18'1"				
22	20'4"				
23	21'1"				
24	21'10"				
25	22'5"				
26	23'0"				
27	23'7"				
28	24'2"				
29	25'10"				Double purchase
30	28'1"				Double purchase
31	29'0"				Double purchase
32	30'8"				
33	31'3"				
34	31'7"				



ELECTRICS

CONTROLS:

ETC Gio Console with motorized fader wing.

ELECTRIC DISCONNECTS

400 Amp ETC Powersafe Pro switch. Upstage Right

400 Amp ETC Powersafe Pro Switch. Midstage Left

200 Amp ETC Powersafe Pro switch. Downstage Left

100 Amp disconnect (stage Left). 35' of tails needed to reach stage left.

Dimmers:

288 ETC Sensor 3 Dimmers with ThruPower modules. Dimmer per Circuit

DMX:

DMX and ETCNet ports throughout the building.

Accessories:

Assorted Lighting Accessories—please ask about something specific.



Lighting Instruments:

Instrument	Quantity	location	misc
Martin Quantum Spot	5		LED
VL770	8		
Seledor Desire D40 Vivid	20		25, 35, 45 degree lenses
Seledor Vivid R 11"	5		
ETC Pars	91		575w lamps, WFLx75, MFLx78, NSPx92, VNSPx96
10 deg ETC Source 4	10		575w lamps
19 deg ETC Source 4	48		
26 deg ETC Source 4	45		
36 deg ETC Source 4	43		
50 deg ETC Source 4	18		
Strand Ianaro Far Cyc	6		3 lamp cyc light
Lycium Follow Spot	2		Midget HP Model 1209 - 575 HMI
Robert Juliat Spot	1		Buxie - 575 MSD

Norton Center has stage pin connectors



SOUND

HOUSE SPEAKER SYSTEM

Mains: House left and right, Meyer Arrays (M1D units, 10 per side)

Delay: 4 Meyer UPJ-1P delay speakers for rear Grand Tier

Subs: Subs only used during concerts

2 Meyer 650P Subs

2 Meyer 600hp Subs

Front Fill: 3 Meyer M1D units

EQ: Galileo 616 Audio Processor on mains, delays, and front fills

TOURING AUDIO TIE-IN TO HOUSE EQ, AMPS, AND SPEAKERS

Splitter tie in Stage Left

In addition, tie-in for house subs and house front fills are available at the house mix position.

Access to the Galileo Processor available.

Minimum 175' of snake from stage left to mix location

FRONT OF HOUSE SYSTEM

Mix Location: The house sound mix position is slightly off center in the rear of the Grand Tier house right. Area is approximately 14 ft wide and 8 ft deep, 100 ft. from the stage.

Due to continental seating, there is no other option.

MIXING CONSOLES

Avid SC48: Digital console, 48 channels in, 16 mixes out (Concert setup only)

Yamaha LS9-32: Digital console, 32 channels in, 16 mixes out. House console

MICROPHONES

Assorted general use and concert microphones available.



MONITOR SYSTEM

*Power for Monitor and isolated monitor split off main house snake is SL.

Power Amps and EQ (8 channels of amps/processors + 4 channels of EQ):

4 Yamaha, 2 channel P7000s power amps, 700W x 2 @8ohms

4 Nexo PS10UTDv analog loudspeaker processor (2 channel)

Speakers:

7 Nexo PS10U 10" 2 Way Monitors

CABLES, SNAKES, OTHER SOUND EQUIPMENT

Permanent 48 channel snake from Ramtech split box to fan-outs at front of house mix position

Ramtech split box with transformer isolated monitor snake feed

Permanent 6 channel snake from Mix position to DSL for returns

Permanent 12 channel snake from Mix position to control room (Galileo position)

Assorted Ramtech snake boxes and XLR snakes for concert use

Assortment of mic stands and cables

COMMUNICATIONS

SL--Dressing room pagePaging all dressing rooms, costume shop, green room, and production office

Video feed from house camera to all dressing rooms , costume shop, green room, and production off

CLEAR COM (2 CHANNEL WIRED)

8 single channel belt packs with single muff headsets

Location of clear com outlets:

Lighting and sound tech booth, FOH (house manager and box office), DSR. DSL, USL, fly rail, orchestra pit, FOH lighting beam (follow spots), scene shop, TD and ATD offices, and FOH mix position.



PROPS

NEWLIN HALL ORCHESTRA PIT (HYDRAULIC LIFT)

48 ft. wide, 12 ft. deep (at 7 ft. below stage level, an additional 4 ft. of depth under the apron of the stage is available)

Musician seating for a maximum of 55

CHAIRS, STANDS, PIANOS, ETC.

150 black Wenger musician chairs

120 Wenger music stands

1 conductors music stand

35 music stand lights

Wenger Versalite Platforms:

19: 4'x8'

6: 2'x8'

Heights w/ legs: 8", 12", 16", 18", 24", 32", 36"

Seated Choral Risers:

3 tier: +8", +16", +24" levels; 3 ft. wide

5-8ft. straight sections, 1-6ft. straight section, 4 wedge sections

Max # on risers: 95; max of 120 with 4th row on floor

Standing Choral Risers

Conductors Platform

Marley to cover stage: black on one side and grey on the other

Pianos:

2: 7 ft. Steinways

1: 9 ft. Steinway--Concert D

Norton Center Staff coordinates all movement and tuning of pianos

WIFI/Internet: The entire building has wireless internet access through CentrePublic WIFI. Wired connections are available in the Production Office and Green Room



WARDROBE

DRESSING ROOMS--Stage Left

Location	No.	Capacity	Mirrors	Lights	Showers	Toilets
Stage level	2 (star)	1-4	Yes	Yes	Yes	Yes
Stage level	2 (small)	4	Yes	Yes	No	Separate
Stage level	2 (chorus)	25	Yes	Yes	No	Separate

ADDITIONAL PRODUCTION ROOMS

Green room

Production office (with 4 phone lines and hardwired internet access)

Costume workroom

EQUIPMENT

2 washers and 2 dryers (in scene shop)

12 rolling racks

2 Jiffy J4000 steamers

2 portable steam irons

2 ironing boards



DRAWINGS

NEWLIN HALL STAGE

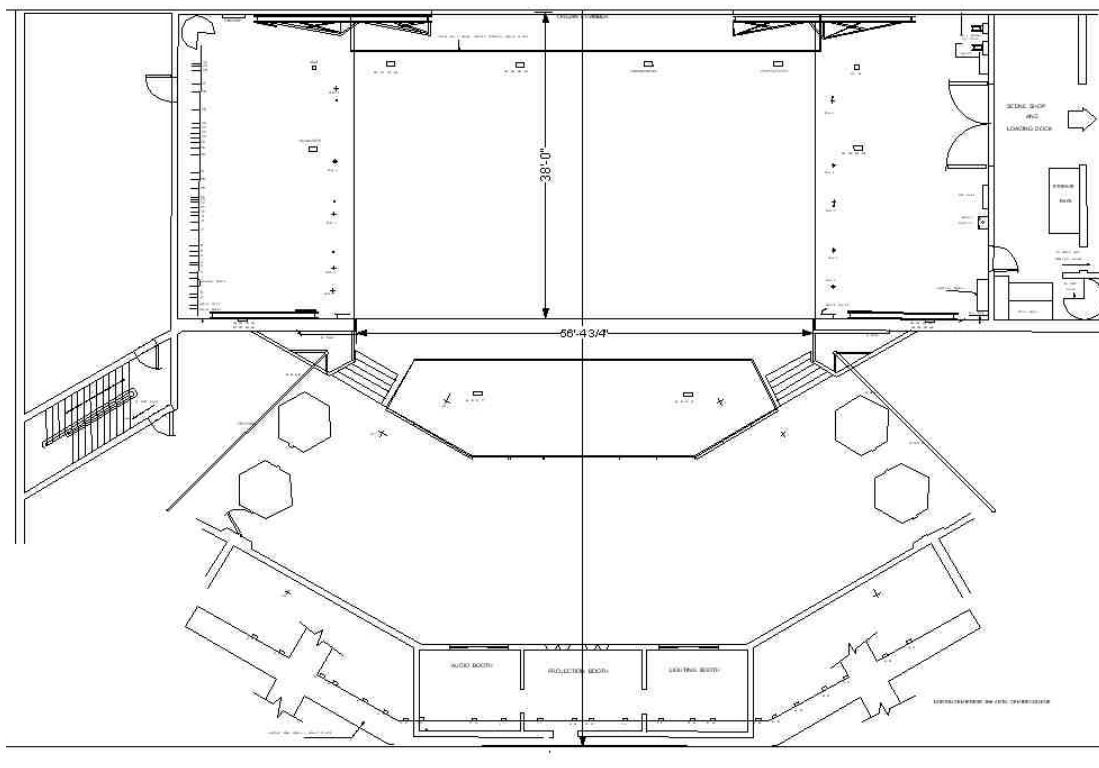
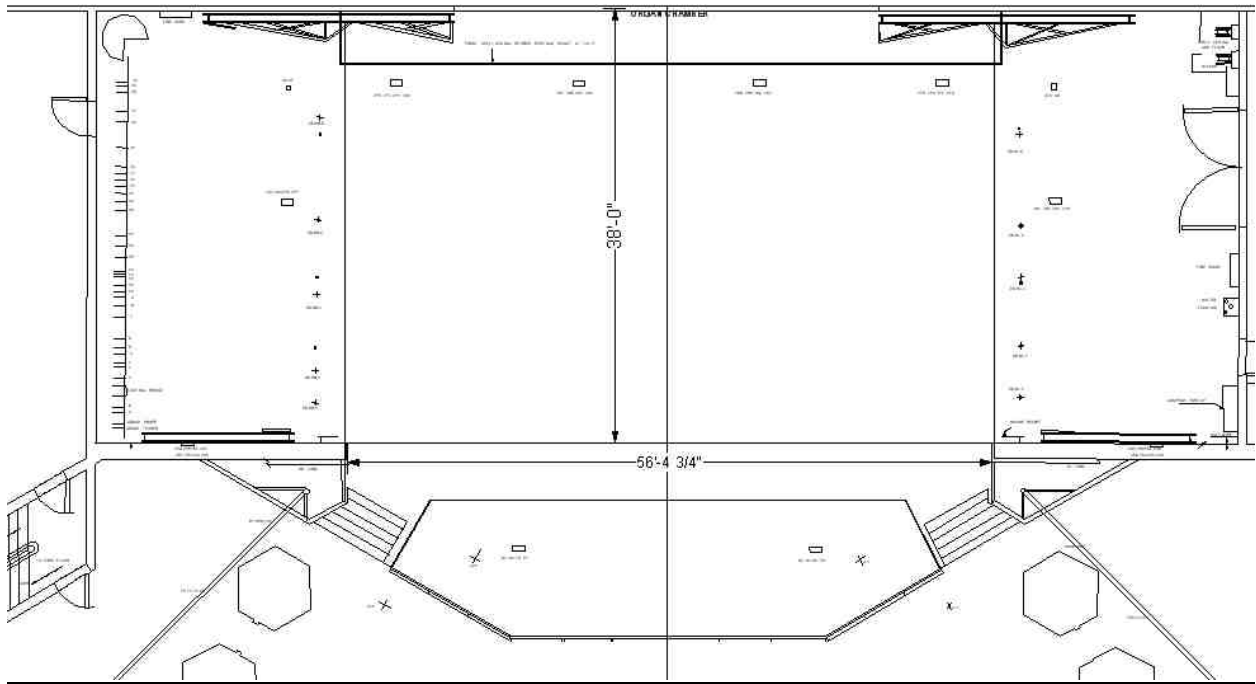

NEWLIN HALL WITH ORCHESTRA SHELL

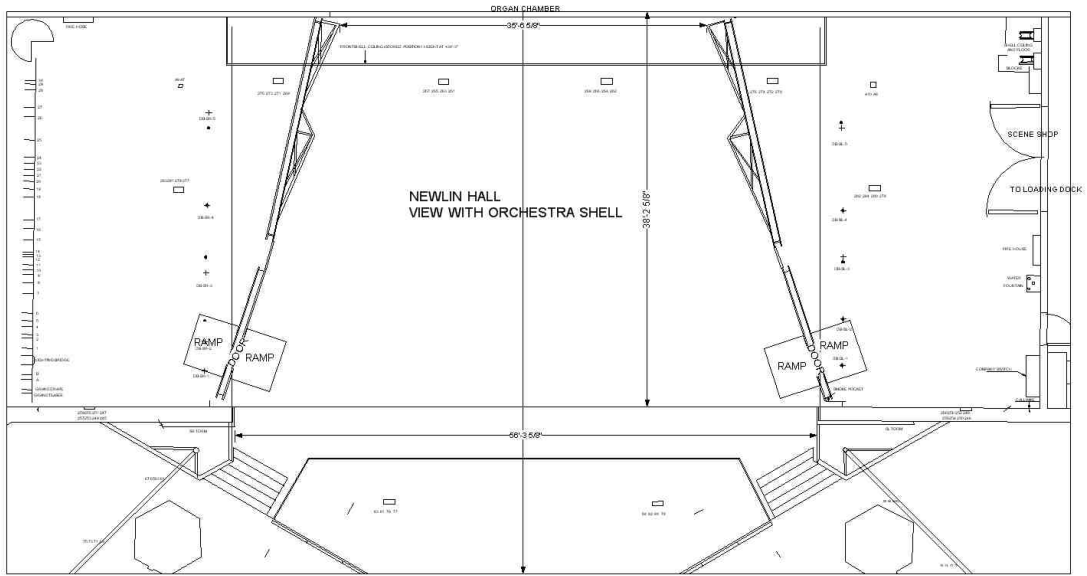

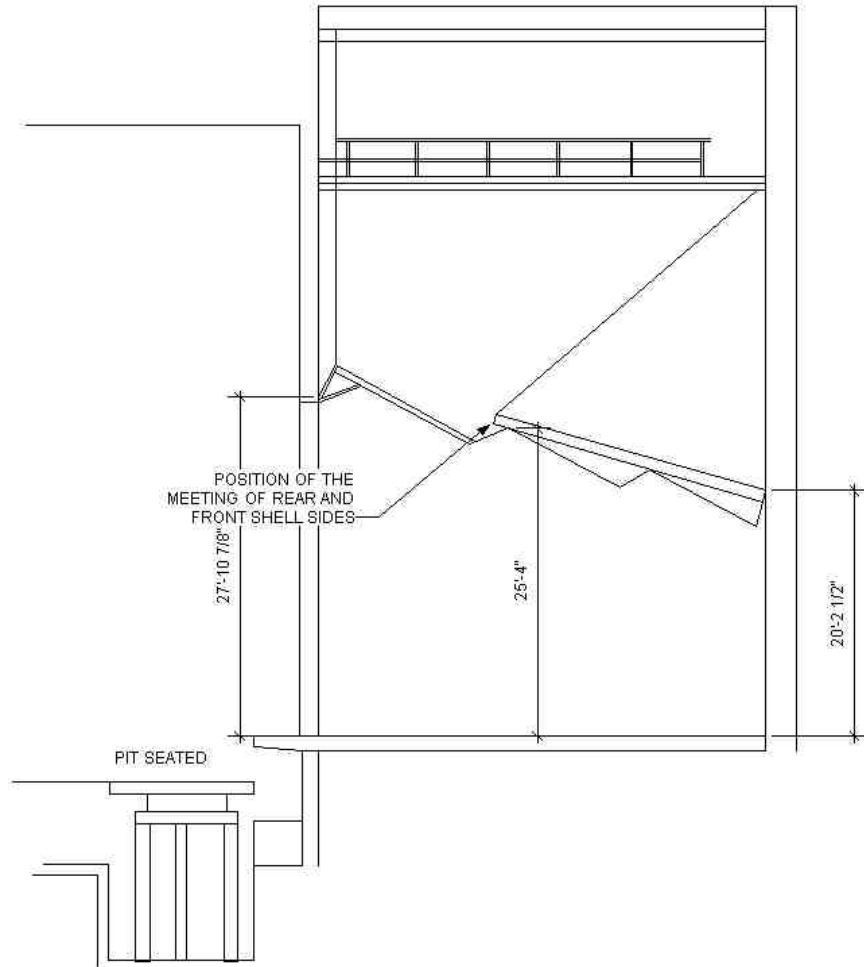

NORTON CENTER FOR THE ARTS BACKSTAGE LAYOUT



NORTON CENTER FOR THE ARTS

CENTRE COLLEGE

DANVILLE, KENTUCKY

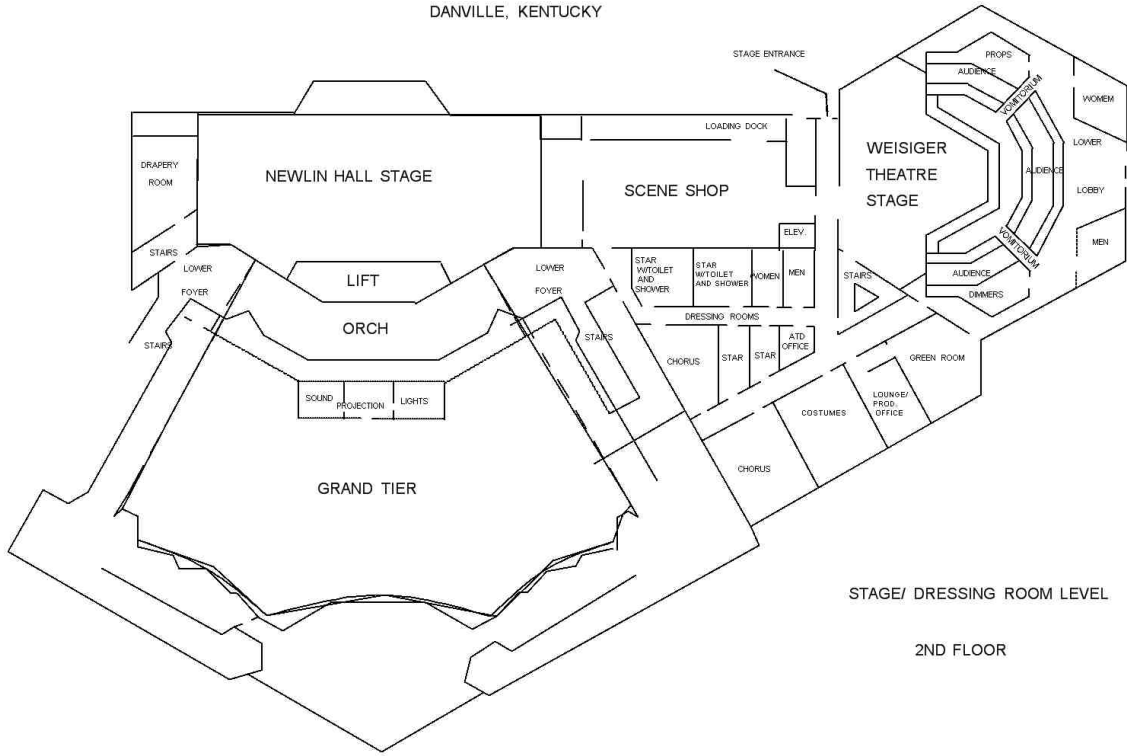

STAGE/ DRESSING ROOM LEVEL

2ND FLOOR

